



Computer Generated Image



**JONES LANG
LASALLE**

Real value in a changing world

THE PENTHOUSE
Central St Giles, WC2
£5,500,000



The sole **Penthouse at Central Saint Giles** is one of the **most impressive London apartments** we have seen and represents the pinnacle of **sophisticated urban living.**

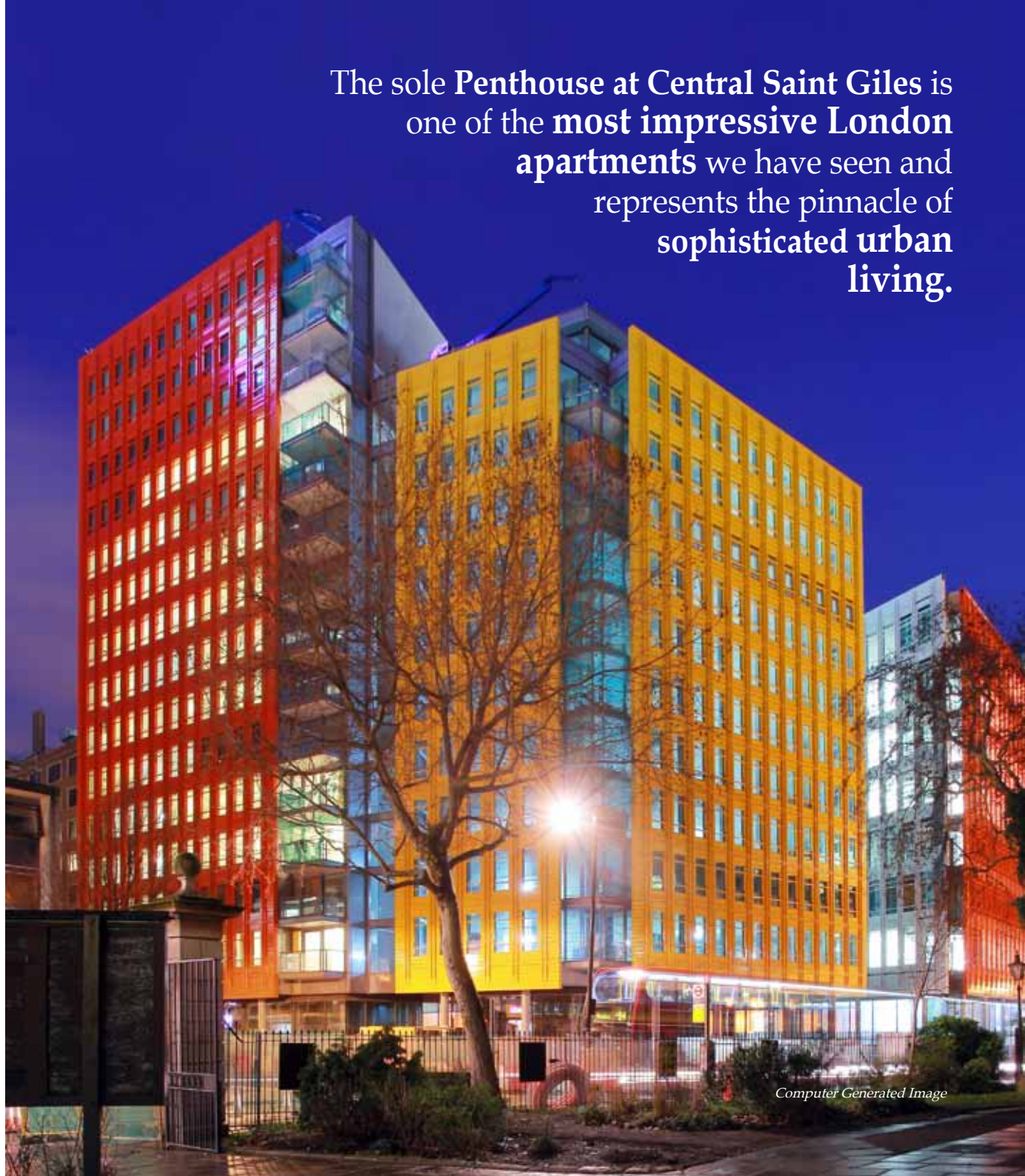

Computer Generated Image

Entered via a private lift, the apartment's **2,426 square feet** are made for entertaining in a sweeping, open-plan layout.



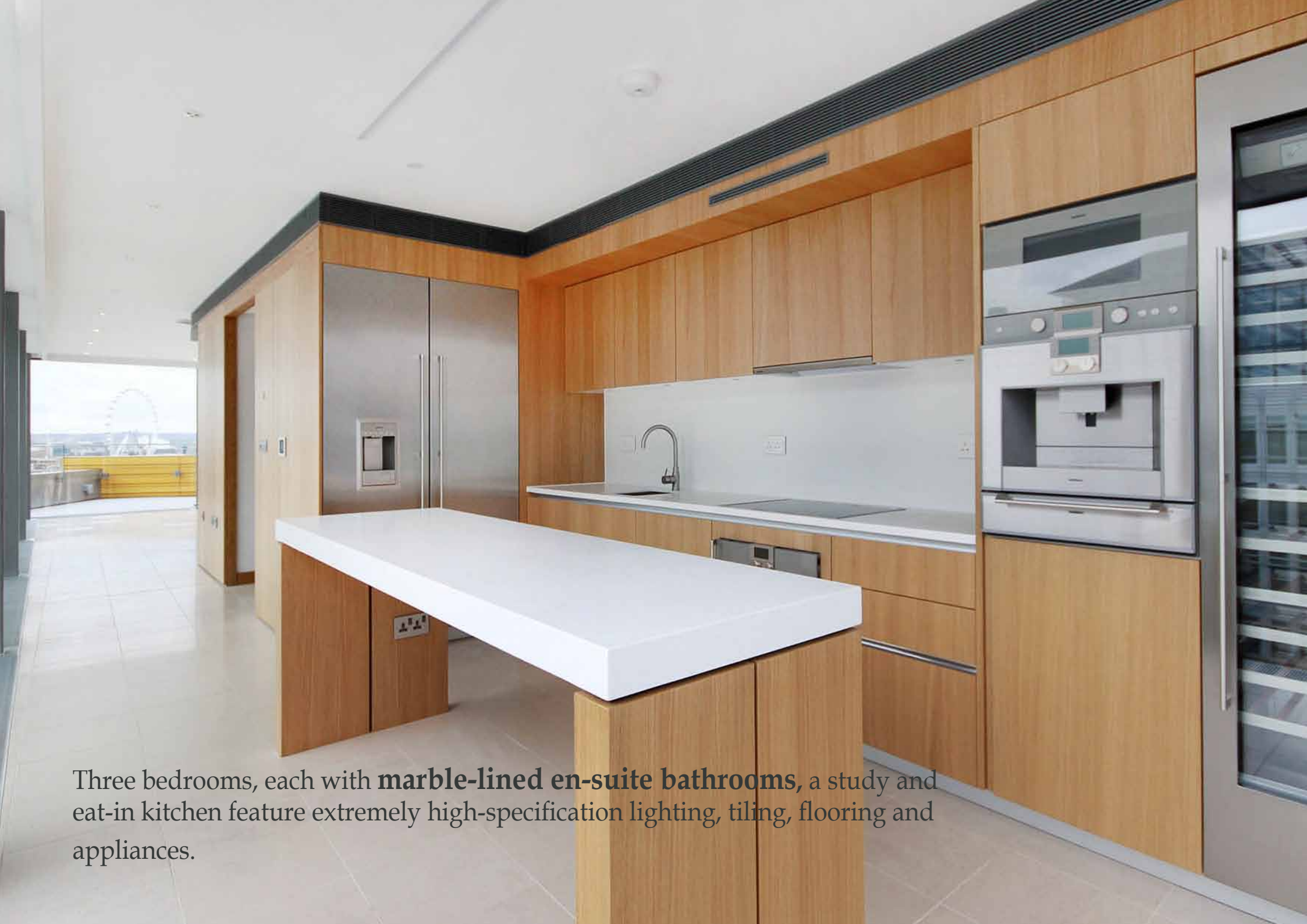

Three bedrooms, each with **marble-lined en-suite bathrooms**, a study and eat-in kitchen feature extremely high-specification lighting, tiling, flooring and appliances.



Computer Generated Image



- 
- A nighttime photograph taken from a balcony, looking out over a cityscape. The central focus is the tall, white, conical spire of St. Martin-in-the-Fields church, topped with a golden cross. The spire is illuminated from below, making it stand out against the dark sky. The surrounding city is lit up with various lights from buildings and streets, creating a warm, golden glow. In the foreground, a dark metal railing of the balcony is visible, and a portion of a brick pillar is seen on the left side. The overall atmosphere is serene and urban.
- ◆ Iconic London landmark building designed by Renzo Piano
 - ◆ Gaggenau appliances & Corian worksurfaces in the kitchen
 - ◆ Oak Joinery & stone flooring
 - ◆ Zoned comfort cooling & underfloor heating
 - ◆ Two secure underground parking spaces included
 - ◆ 24 hour concierge service

Panoramic floor-to-ceiling windows throughout, leading onto 1238 square feet of private decked terrace overlooking the lights of London's West end, enjoying some of the **City's finest views.**

On the top of the **world.**



Computer Generated Image

CENTRAL ST GILES, WC2

Approx. Gross Internal Area
2426 sq ft 225.4 sq m
Approx Terrace Area
1238 sq ft 115 sq m

Lease Length 150 Years
Ground Rent £750 Per Annum
Estimated Service Charge
£6.50 per Sq Ft Per Annum

Jones Lang LaSalle
International Desk
30 Warwick Street
W1B 5NH
T +44 (0)20 7993 7395
portfolio.london@eu.jll.com
www.joneslanglasalle.co.uk

Disclaimer:
Property Misdescriptions Act 1991: The particulars contained in this brochure have been produced in good faith, are set out as a general guide and do not constitute the whole or part of any contract. All liability, in negligence or otherwise, arising from the use of these particulars is hereby excluded. Brochure by www.cpcreative.co.uk

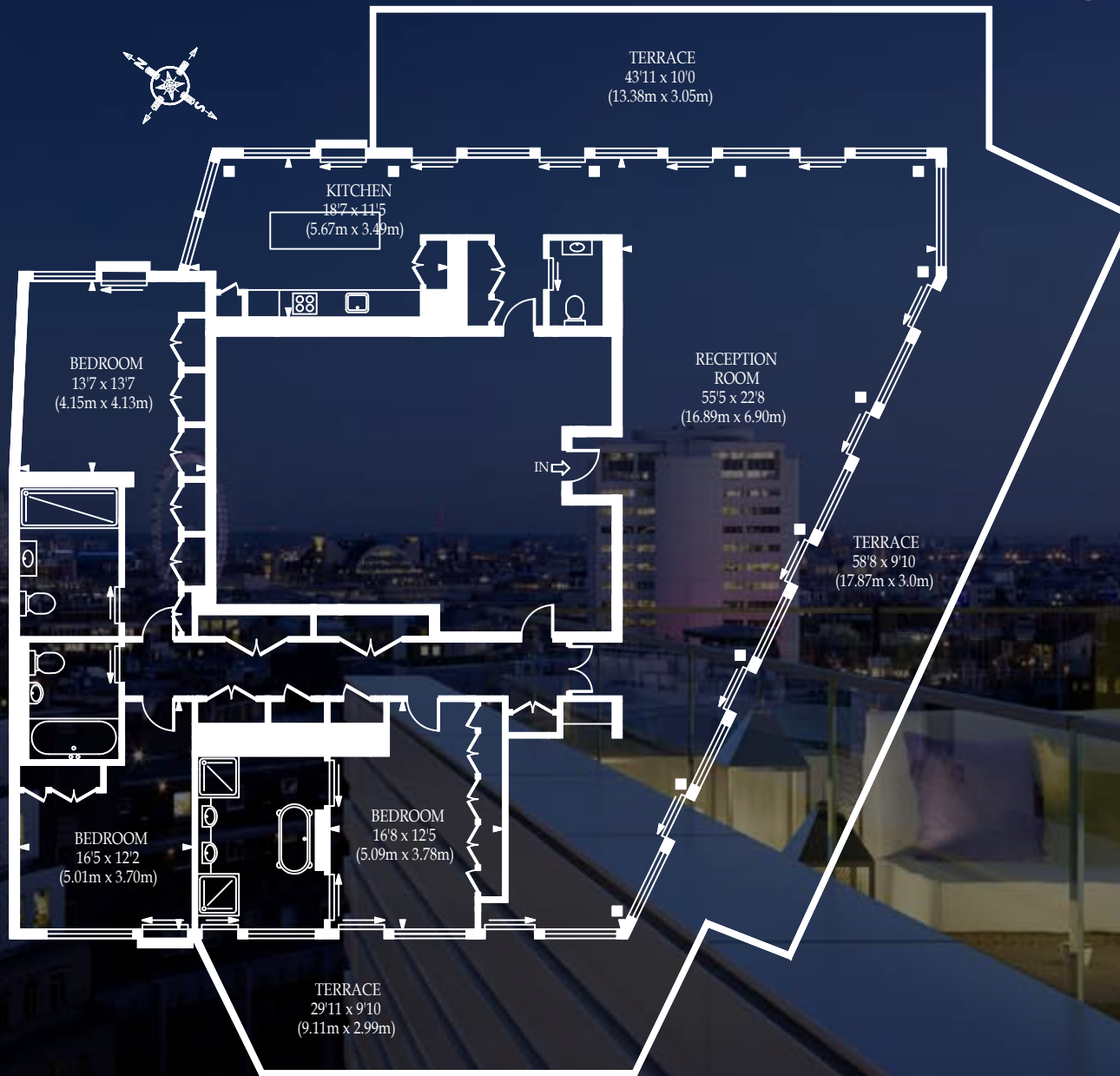

ELEVENTH FLOOR